

1. DB 200 - Sensor Outside Door

1. Attach sensor to outside of door.
2. Plug signaler into wall outlet.
3. Plug lamp into signaler.

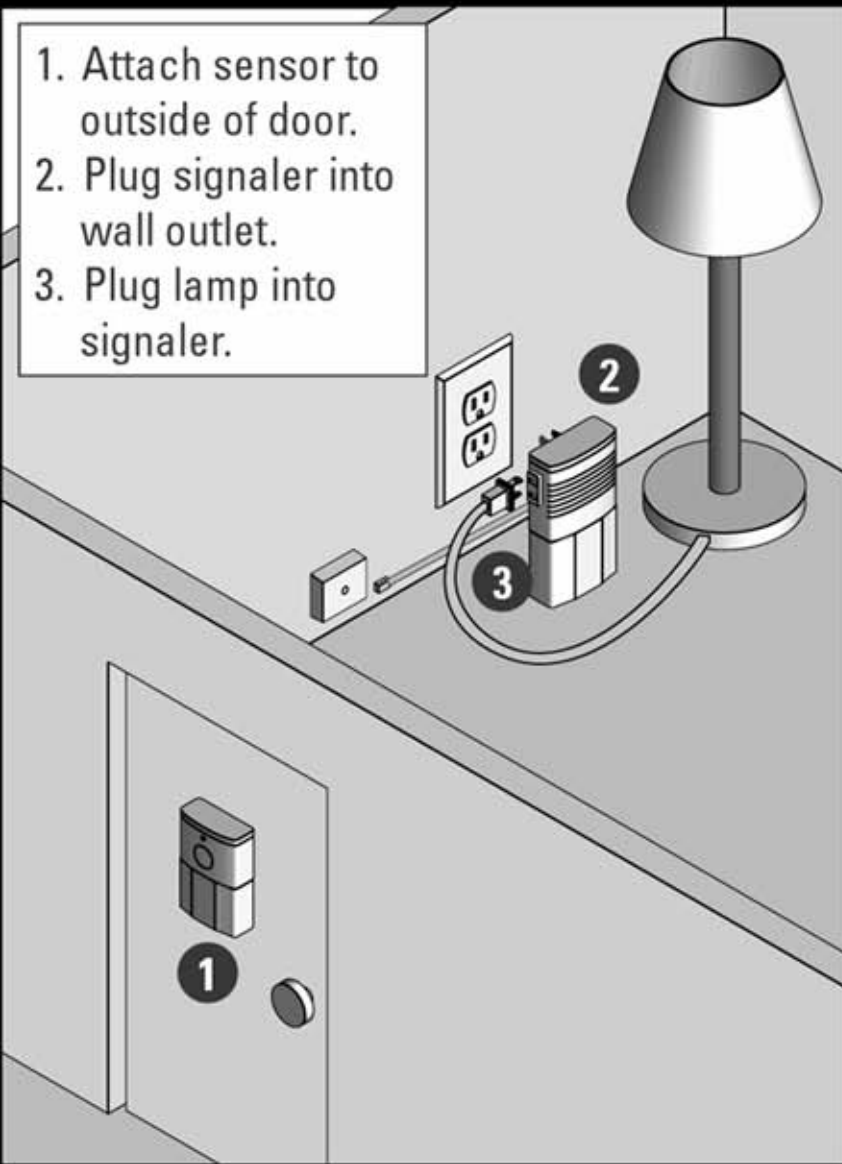

2. DB 200 - Sensor Wired to Chime

1. Wire sensor into chime for batteryless operation.
2. Plug signaler into wall outlet.
3. Plug lamp into signaler.

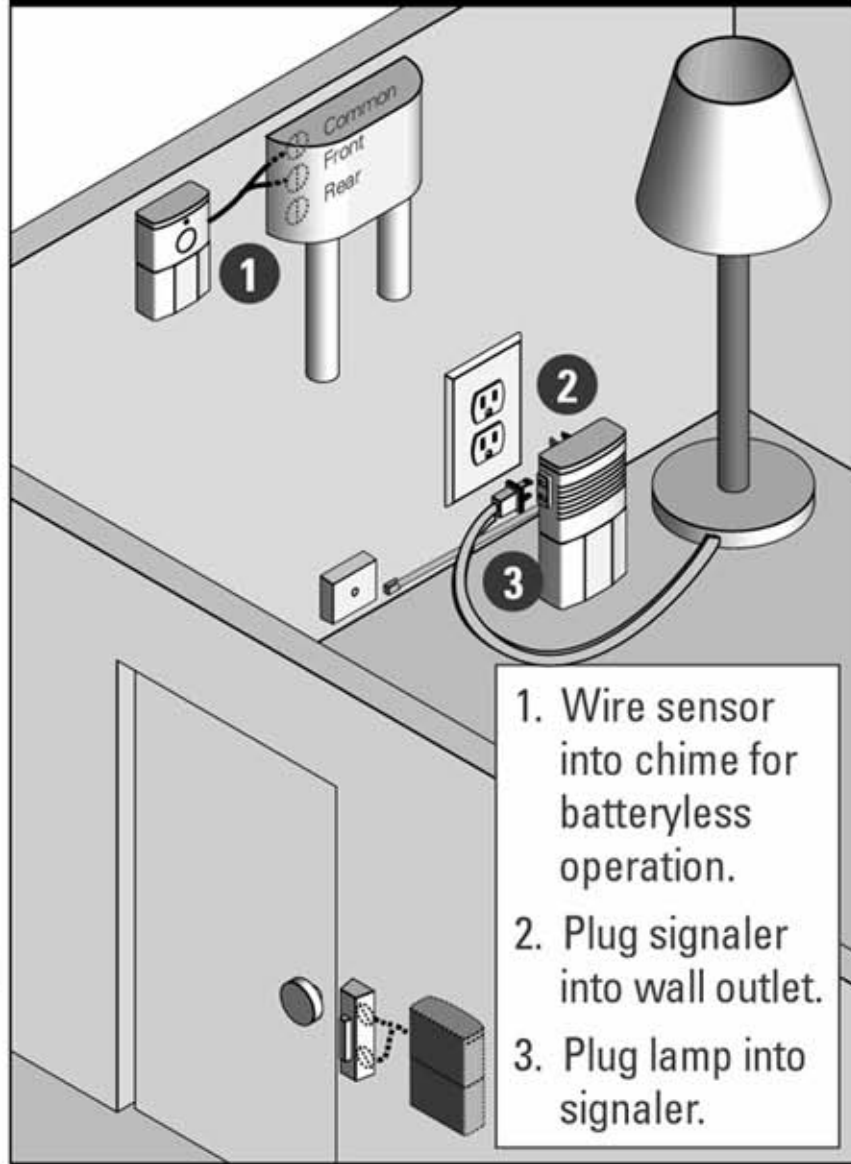

3. DB 200 - Sensor on Chime

1. Attach sensor to doorbell chime.
2. Plug signaler into wall outlet.
3. Plug lamp into signaler.

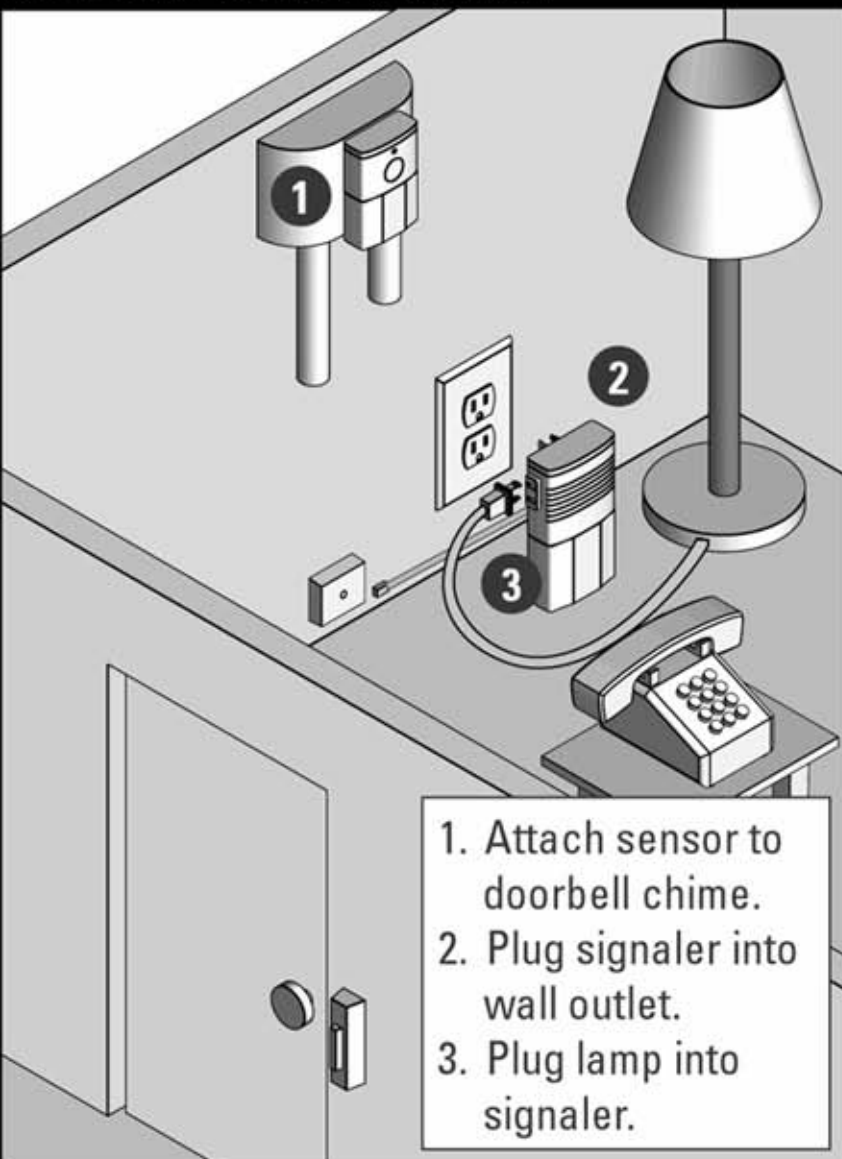

4. DB 200 - Sensor on Intercom

1. Attach sensor to intercom.
2. Plug signaler into wall outlet.
3. Plug lamp into signaler.
4. Plug phone cord into phone jack.

